

LOG ON AT HOME

Access: Internet Explorer on desktop

- A. Type – <https://my.cfsd.net> in address line to access login screen. Enter Network Username and Password. Click Log In.

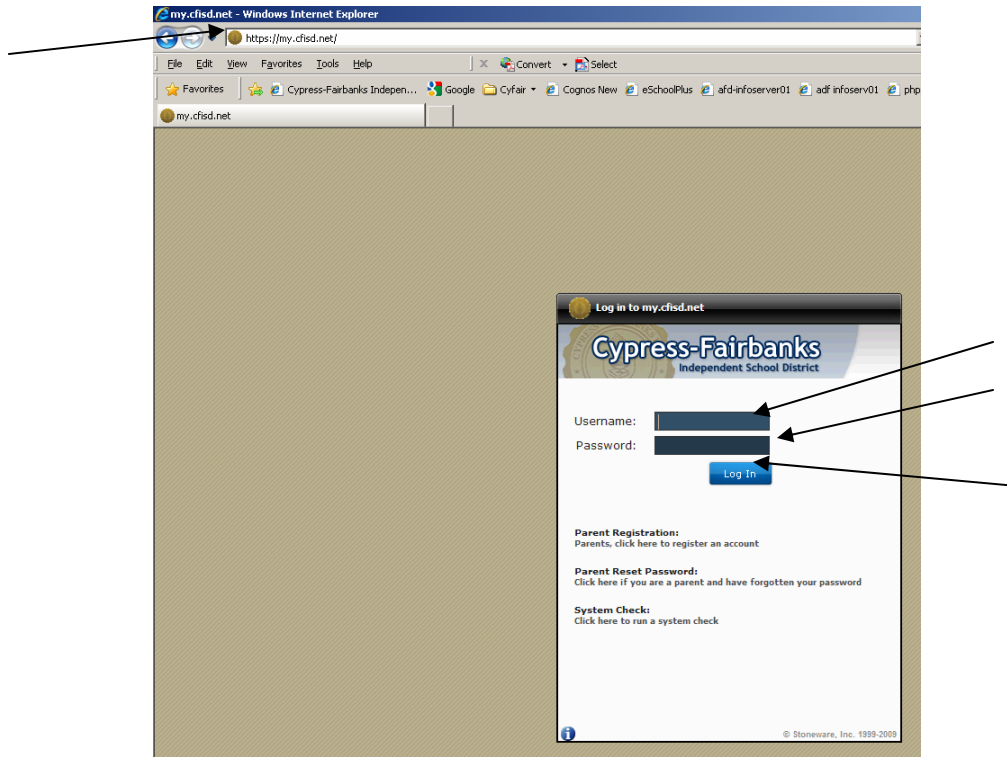

- B. On the District Information Screen, click on Links >eSchoolPlus

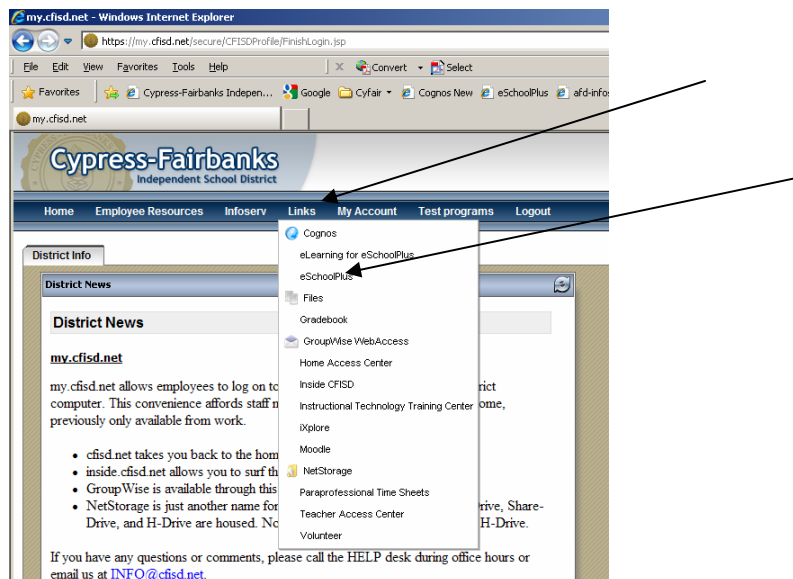

C. On eSchool login screen, enter Network User Name and Password. Click OK.

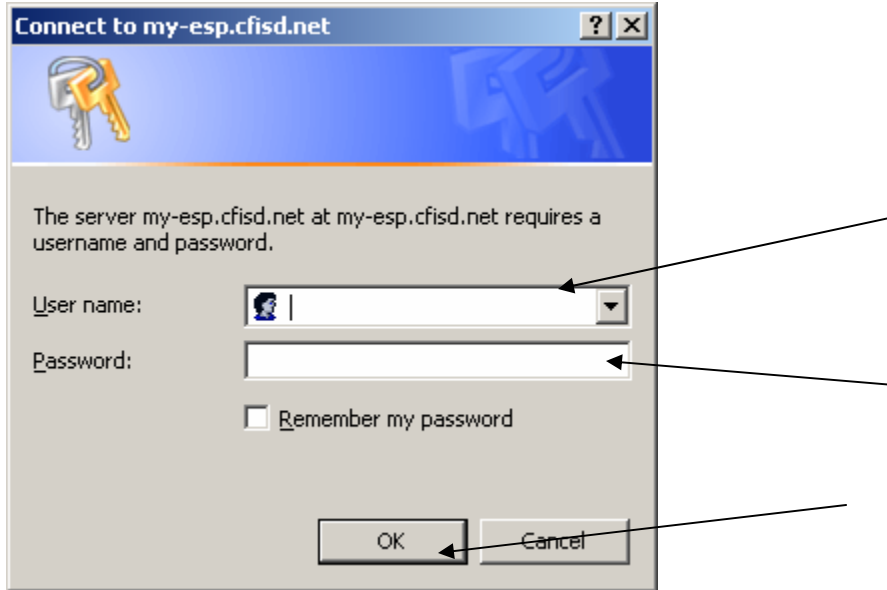

D. Click OK on environment screen to accept live database and current year.

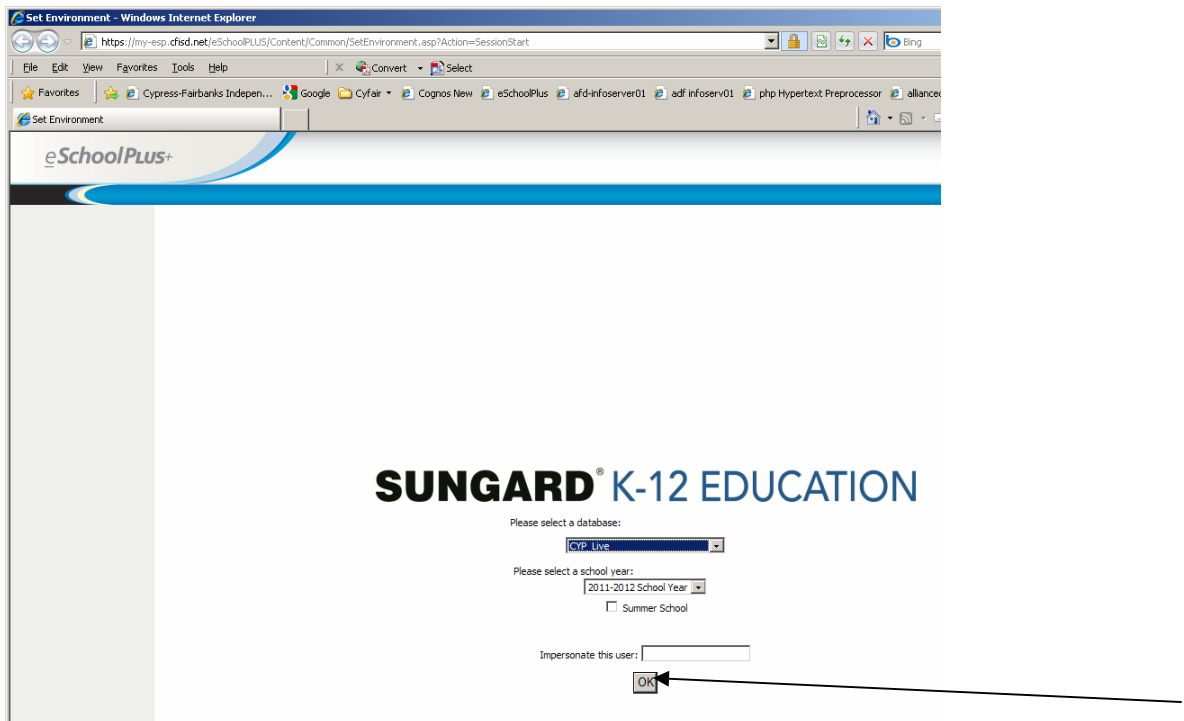

E. Your eSchoolPLUS home page will be displayed.